

APPENDIX J

Sample Maps of the City's Sanitary Sewer System

City of Glendale

City of Glendale Sanitary Sewer Atlas Legend



Sanitary Sewer System Statistics

Length of Sewer Mainlines: 354.3 Miles (1,870,632.1 Feet)
 No. of Pipes: 7780 Distinct Pipes
 No. of Manholes: 7419
 No. of Gauging Stations: 7
 No. of Laterals: 44,832
 No. of Sewer Permits: 35,207

Legend

Sewer Nodes

- ◆ Mainline Cleanout
- ⊗ Mainline Diversion
- ⊙ Drop Manhole
- ⊙ Flume
- Flume & Perm Gauging Sta.
- ⊙ Junction Chamber
- ⊙ Manhole
- ▽ Offset
- Other
- ⊙ Point of Entry
- ⊙ Point of Exit
- Pumping Plant
- Siphon Connect Point
- Mainline Stubout
- Outfall Stubout
- ⊙ Unknown

Sewer Mains

- Bypass
- Mainline
- Other; Unknown
- Vertical Curved Pipe

Sewer Laterals

- Cap
- Saddle
- Saddle & Cap
- Standard Lateral
- Parcels
- Centerlines
- Bldg Footprints
- Transportation

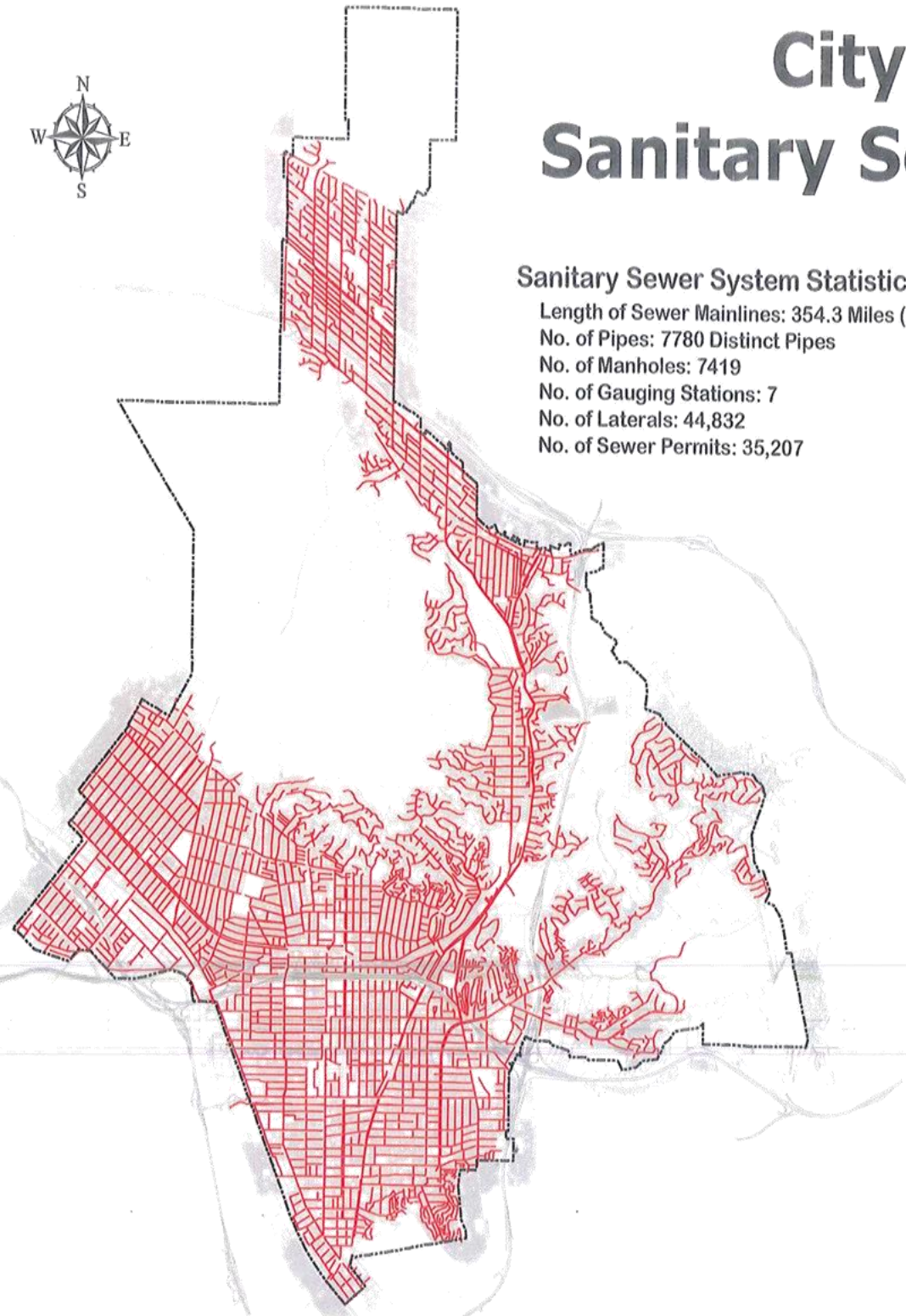

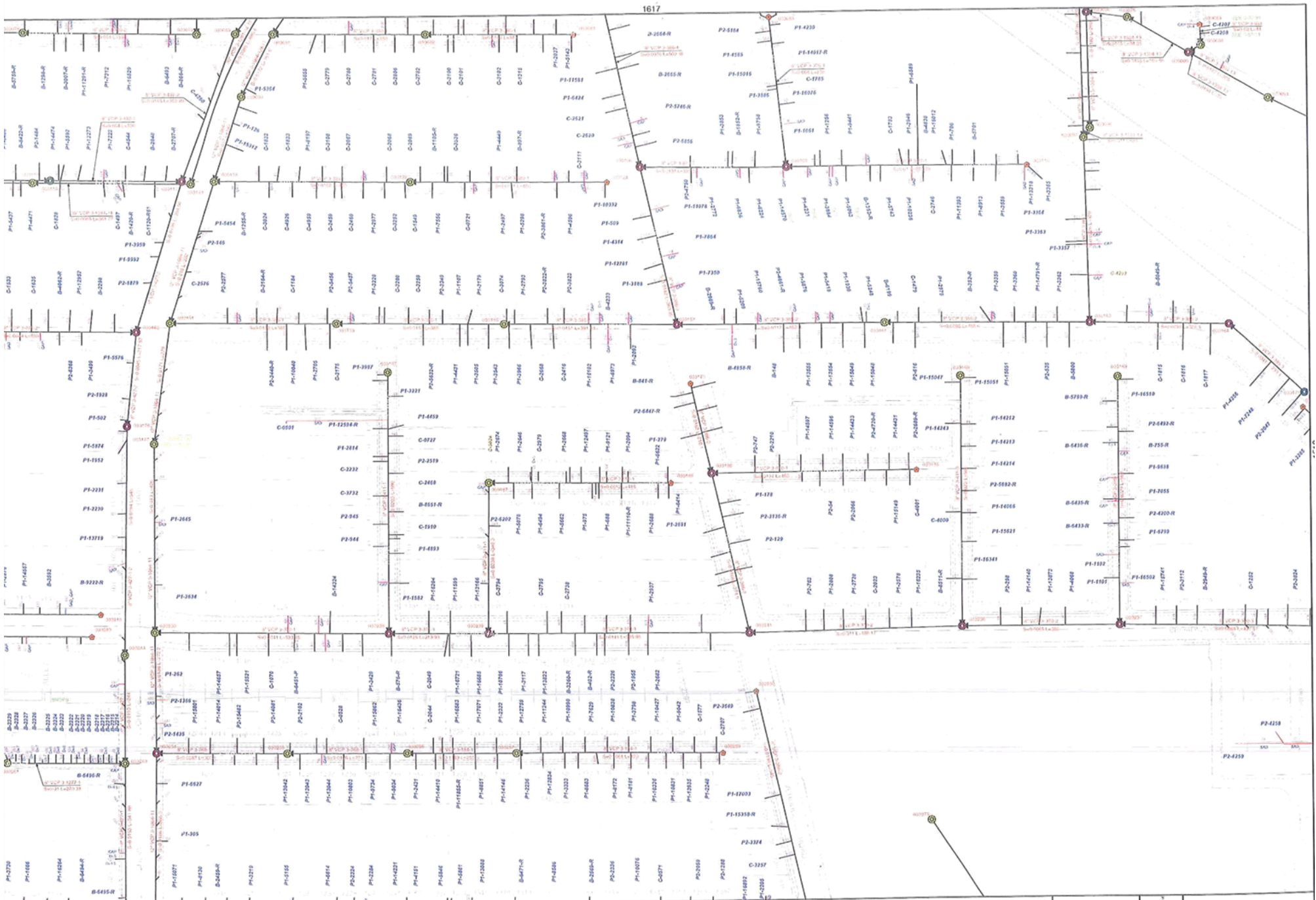

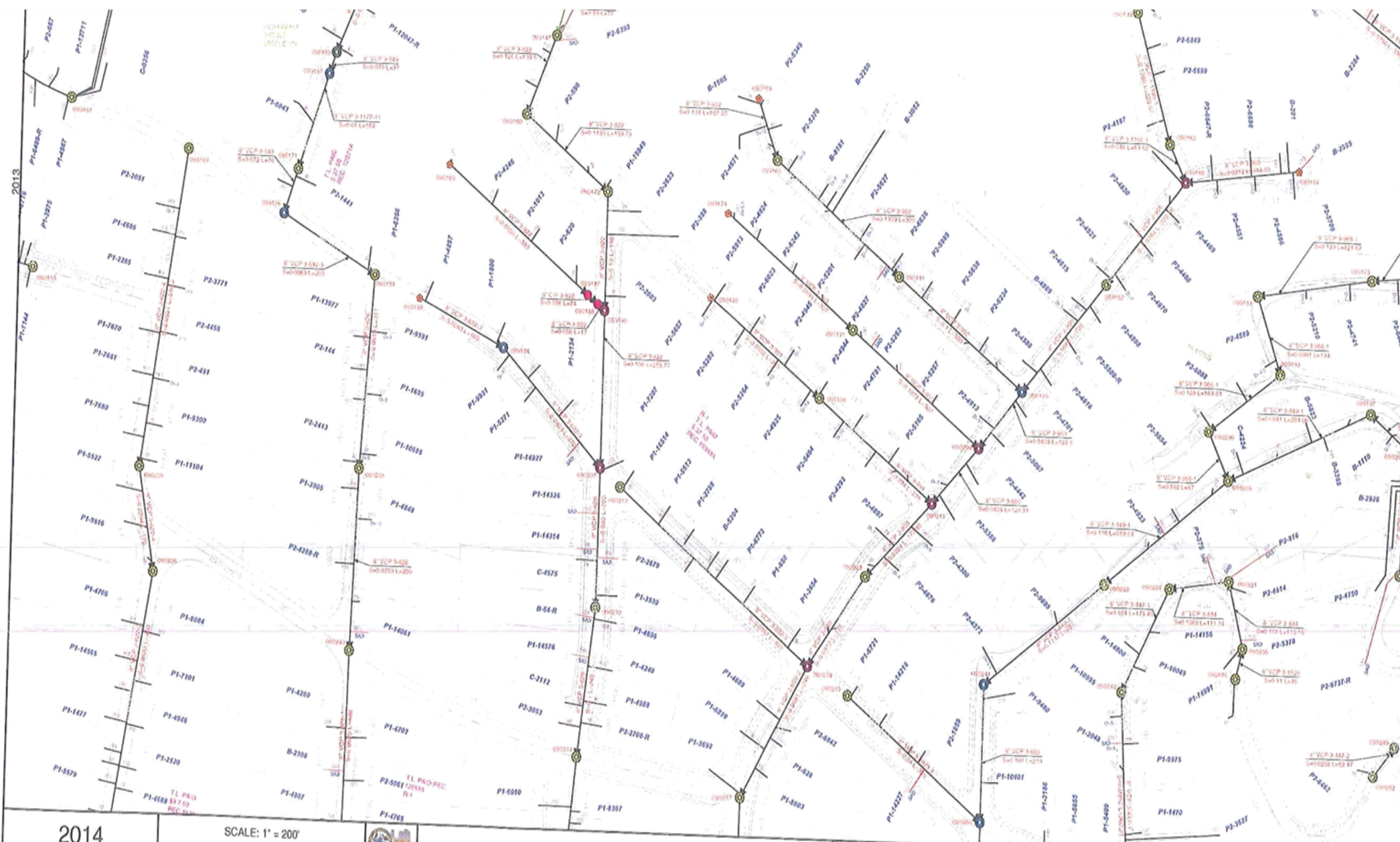

2014

SCALE: 1" = 200'
NOT FOR CONSTRUCTION USE



SEWER SYSTEM MAP

CITY OF GLENDALE

October 2004

